

BC-4** / TSCR / TSB2 / SF24-OCT

(3" O/D Fluted Breakaway Pole w/ Street Sign Mount and Octagon Sign Frame)

Poles available in the following heights:
10 ft. - 12 ft. - 14 ft. - 16ft.

How to Order: *(example)*
BC-4** / TSCR / TSB2 / SF24-OCT-BLK
Pole / Street Sign Mount / Pole Topper / Sign Frame-Color
(indicates pole height)*



Breakaway Certified Pole -

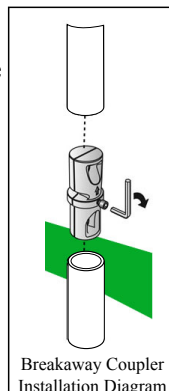
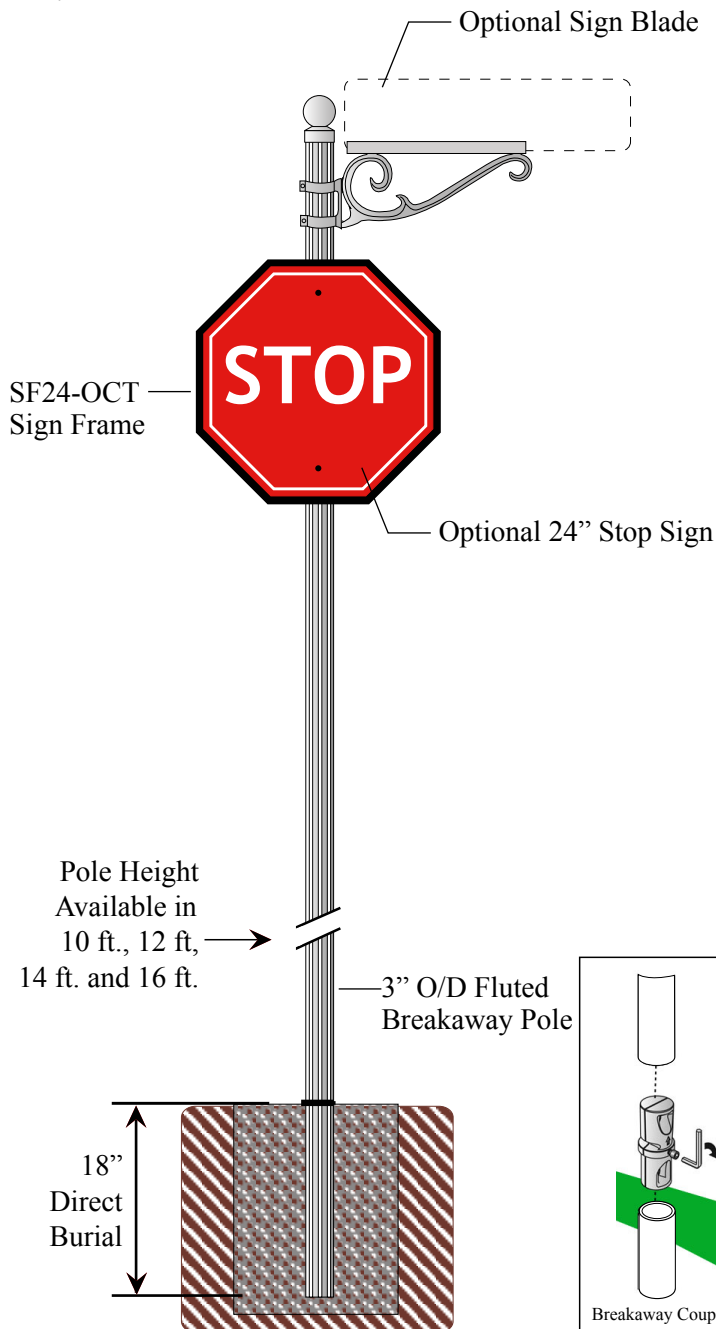

BC-4** Fluted Breakaway Pole

- 3" O/D Fluted Breakaway Pole
- Made of Extruded Aluminum
- .095 Wall Thickness
- Direct Burial



TSCR - Single Street Sign Mount

- Clamps around any 3" O/D pole
 - Can be ordered to hold any size sign blade
 - Made of Extruded Aluminum
- (See Traffic Pole Accessories Section for product specifications)*

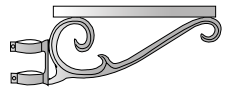

TSB2 - Cannon Ball Post Topper

- Decorative Post Topper that fits 3" O/D round post.
- Made of Cast Aluminum.
- 3 3/4" wide x 4 3/8" tall



Additional Post Topper Options:



TSB4

TSB5

TSB7

TSB10

SF24-OCT Sign Frame

- Fits around 24" Stop Sign
- Has a 1" square edge on all sides
- Made of Cast Aluminum

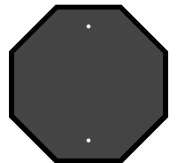

Finish

- The fixture will be finished with a premium quality thermoset polyester powdercoat for a durable finish.

Installation Instructions for Direct Burial Poles:

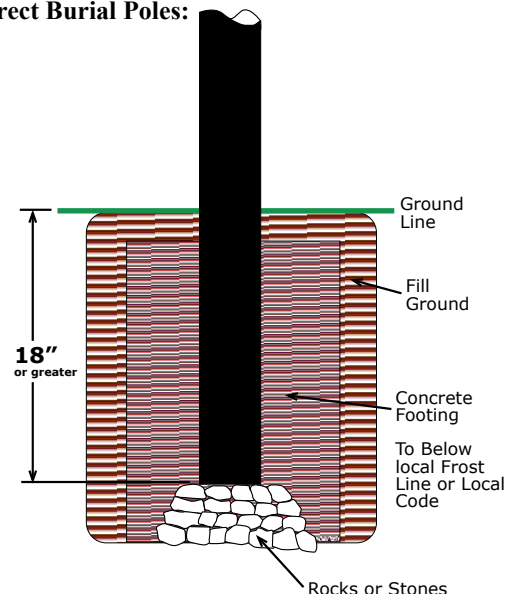

1634 Latrobe-Derry Road • Loyallhanna, PA 15661 • Phone: (724) 537-4711 • Fax: (724) 537-9313

www.specialliteproducts.com • customer_service@specialliteproducts.com